



## Link Vent 5000,4000 & 2500

### Operation & Maintenance Manual

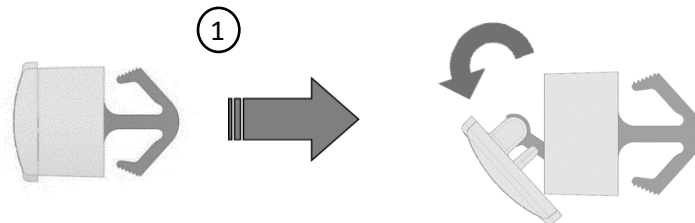
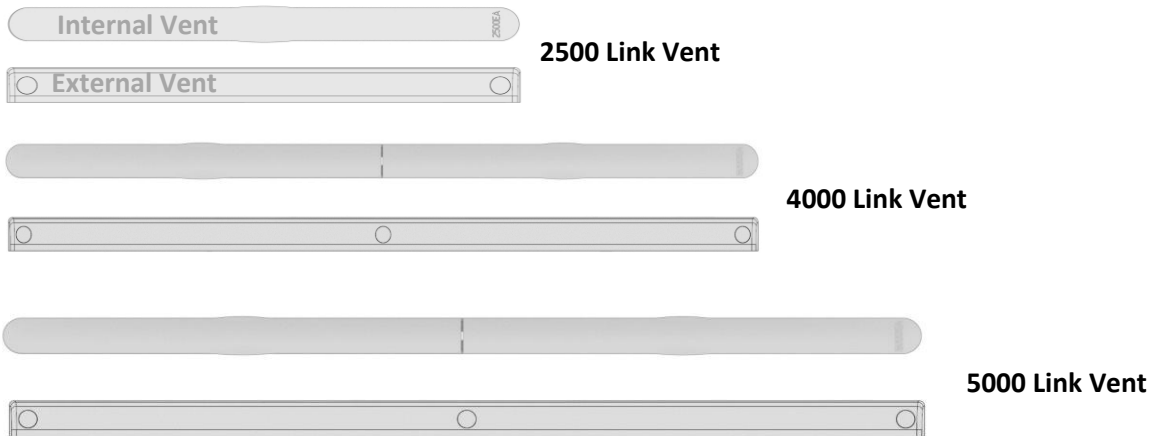

Figure1. Link Vent internal lid opening

#### **Operation:**

- Open and close the vent by tilting the lid on the internal vent, 4000 & 5000 version has two lids which operate independently to each other.
- The Lid can be tilted to direct the air in the desired direction as shown on *figure 1*.

#### **Maintenance:**

- Every 3 months gently brush the external canopy with a hand brush to remove any cobwebs and wipe down with soapy water using a damp cloth.
- Do not use abrasive cleaning products or abrasive cleaning materials.
- Where possible, gently open the internal vent and vacuum the cut-out rout clearing out any dust and debris for efficient performance.
- Every 3 months gently brush the internal vent with a hand brush to remove any cobwebs and wipe down with soapy water using a damp cloth.

